

FEC FORM 1

STATEMENT OF ORGANIZATION

RECEIVED

2014 MAR 11 PM 3:49

Office Use Only

FEC MAIL CENTER

12FE4M5

1. NAME OF COMMITTEE (in full)

(Check if name is changed)

Example: If typing, type over the lines.

Restore Democracy

ADDRESS (number and street)

6 E Street, SE

(Check if address is changed)

Washington

DC

20003

CITY

STATE

ZIP CODE

COMMITTEE'S E-MAIL ADDRESS (Please provide only one e-mail address)

(Check if address is changed)

vwinpisinger@msn.com

COMMITTEE'S WEB PAGE ADDRESS (URL)

(Check if address is changed)

2. DATE

03 / 5 / 2014

3. FEC IDENTIFICATION NUMBER

C

4. IS THIS STATEMENT



NEW (N)

OR



AMENDED (A)

I certify that I have examined this Statement and to the best of my knowledge and belief it is true, correct and complete.

Type or Print Name of Treasurer

James A. DeChaine

Signature of Treasurer

3/5/14

Date

M M / D D / Y Y Y Y

NOTE: Submission of false, erroneous, or incomplete information may subject the person signing this Statement to the penalties of 2 U.S.C. §437g.

ANY CHANGE IN INFORMATION SHOULD BE REPORTED WITHIN 10 DAYS.

Office Use Only

For further information contact: Federal Election Commission Toll Free 800-424-9530 Local 202-694-1100

FEC FORM 1 (Revised 02/2009)

14031193846

5. TYPE OF COMMITTEE

Candidate Committee:

- (a) This committee is a principal campaign committee. (Complete the candidate information below.)
- (b) This committee is an authorized committee, and is NOT a principal campaign committee. (Complete the candidate information below.)

Name of Candidate _____

Candidate Party Affiliation _____ Office Sought: House Senate President State _____ District _____

- (c) This committee supports/opposes only one candidate, and is NOT an authorized committee.

Name of Candidate _____

Party Committee:

- (d) This committee is a _____ (National, State or subordinate) committee of the _____ (Democratic, Republican, etc.) Party.

Political Action Committee (PAC):

- (e) This committee is a separate segregated fund. (Identify connected organization on line 6.) Its connected organization is a:
 - Corporation Corporation w/o Capital Stock Labor Organization
 - Membership Organization Trade Association Cooperative
 - In addition, this committee is a Lobbyist/Registrant PAC.

- (f) This committee supports/opposes more than one Federal candidate, and is NOT a separate segregated fund or party committee. (i.e., nonconnected committee)
 - In addition, this committee is a Lobbyist/Registrant PAC.
 - In addition, this committee is a Leadership PAC. (Identify sponsor on line 8.)

Joint Fundraising Representative:

- (g) This committee collects contributions, pays fundraising expenses and disburses net proceeds for two or more political committees/organizations, at least one of which is an authorized committee of a federal candidate.
- (h) This committee collects contributions, pays fundraising expenses and disburses net proceeds for two or more political committees/organizations, none of which is an authorized committee of a federal candidate.

Committees Participating in Joint Fundraiser

1. _____ FEC ID number C
2. _____ FEC ID number C
3. _____ FEC ID number C
4. _____ FEC ID number C

14031193847

Write or Type Committee Name

Restore Democracy

6. Name of Any Connected Organization, Affiliated Committee, Joint Fundraising Representative, or Leadership PAC Sponsor

Richard M. Nolan

Mailing Address

31516 Old Bridge Road

Crosby

MN

56441

CITY

STATE

ZIP CODE

Relationship:

Connected Organization

Affiliated Committee

Joint Fundraising Representative

Leadership PAC Sponsor

7. Custodian of Records: Identify by name, address (phone number -- optional) and position of the person in possession of committee books and records.

Full Name

Vickie L. Winpisinger

Mailing Address

315 Inspiration Lane

Gaithersburg

MD

20878

Title or Position

CITY

STATE

ZIP CODE

Assistant Treasurer

Telephone number

301

947

0278

8. Treasurer: List the name and address (phone number -- optional) of the treasurer of the committee; and the name and address of any designated agent (e.g., assistant treasurer).

Full Name of Treasurer

James A. DeChaine

Mailing Address

3080 Tudor Road

Riva

MD

21140

CITY

STATE

ZIP CODE

Title or Position

Treasurer

Telephone number

410

956

5824

14031193848

Full Name of Designated Agent

[Grid for Full Name of Designated Agent]

Mailing Address

[Grid for Mailing Address Line 1]

[Grid for Mailing Address Line 2]

[Grid for Mailing Address Line 3]

CITY

STATE

ZIP CODE

Title or Position

[Grid for Title or Position]

Telephone number

[Grid for Telephone number]

9. Banks or Other Depositories: List all banks or other depositories in which the committee deposits funds, holds accounts, rents safety deposit boxes or maintains funds.

Name of Bank, Depository, etc.

Bank of America

Mailing Address

PO Box 15284

[Grid for Mailing Address Line 2]

Wilmington

DE

20883

CITY

STATE

ZIP CODE

Name of Bank, Depository, etc.

[Grid for Name of Bank, Depository, etc.]

Mailing Address

[Grid for Mailing Address Line 1]

[Grid for Mailing Address Line 2]

[Grid for Mailing Address Line 3]

CITY

STATE

ZIP CODE

14031193849



SS

Extremely Urgent

From: (301) 947-0178
Vickie Wimpinger
Wimpinger & Associates, Inc.
315 Inspiration Lane
Gaithersburg, MD 20878

Origin ID: EDGA



JK101-02070304

BILL SENDER

SHIP TO: (202) 694-1000
Federal Election Commission

999 E Street, NW

Washington, DC 20463

Ship Date: 10MAR14
ActWgt: 1.0 LB
CAD: 417794/NET3480

Delivery Address Bar Code



Ref # Restore Democracy

Invoice #

PO #

Dept #

WED - 12 MAR AA

** 2DAY **

TRK# 7981 5762 9749



19 RDVA

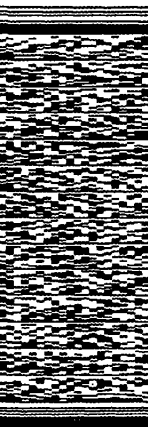

20463

DC-US

IAD

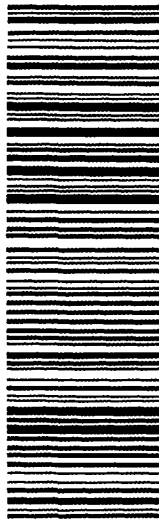

52610CCEPF20

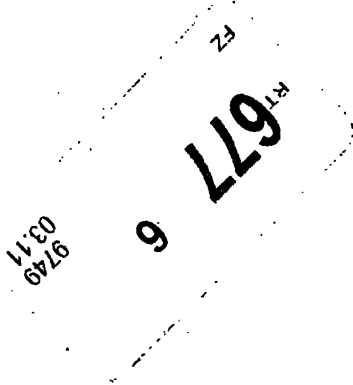

Container and conditions and the FedEx FedEx Service services, fedex.com.

Insert shipping document here

After printing this label:

1. Use the Print button on this page to print your label to your laser or inkjet printer.
2. Fold the printed page along the horizontal line.
3. Place label in shipping pouch and affix it to your shipment.

Warning: Use only the printed original label for shipping. Use of this system constitutes your agreement to the service package, whether the result of loss, damage, delay, non-claim. Limitations found in the current FedEx Service Guide, fees, costs, and other forms of damage whether direct, indirect, or consequential.

X-RAYED BY FEC SECURITY

Shipping purposes is fraudulent and could result in additional billing charges, along with the cancellation of your FedEx account number. FedEx.com FedEx will not be responsible for any claim in excess of \$100 per value, pay an additional charge, document your actual loss and file a timely claim. Recovery cannot exceed actual or the authorized declared value.

Federal Election Commission
ENVELOPE REPLACEMENT PAGE FOR INCOMING DOCUMENTS
 The FEC added this page to the end of this filing to indicate how it was received.

Hand Delivered Date of Receipt

USPS First Class Mail Postmarked

USPS Registered/Certified Postmarked (R/C)

USPS Priority Mail Postmarked

USPS Priority Mail Express Postmarked

Postmark Illegible

No Postmark

Overnight Delivery Service (Specify): *Fed Ex* Shipping Date
3/10/14
Next Business Day Delivery

Received from House Records & Registration Office Date of Receipt

Received from Senate Public Records Office Date of Receipt

Received from Electronic Filing Office Date of Receipt

Other (Specify): Date of Receipt or Postmarked

R *3/12/14*
 PREPARER DATE PREPARED

14031193851