

FEC FORM 3X

REPORT OF RECEIPTS AND DISBURSEMENTS For Other Than An Authorized Committee

RECEIVED FEC MAIL OPERATIONS CENTER

2006 MAR -1 A 7 39

Office Use Only

1. NAME OF COMMITTEE (In full)

TYPE OR PRINT

Example: If typing, type over the lines.

12FE4M5

DELAWARE COUNTY DEMOCRATIC COMMITTEE

ADDRESS (number and street)

P.O. BOX 473



Check if different than previously reported. (ACC)

MEDIA

PA

19003

2. FEC IDENTIFICATION NUMBER

CITY

STATE

ZIP CODE

00404590

3. IS THIS REPORT



NEW (N)

OR



AMENDED (A)

4. TYPE OF REPORT (Choose One)

(a) Quarterly Reports:

- April 15 Quarterly Report (Q1)
July 15 Quarterly Report (Q2)
October 15 Quarterly Report (Q3)
January 31 Year-End Report (YE)
July 31 Mid-Year Report (Non-election Year Only) (MY)
Termination Report (TER)

(b) Monthly Report Due On:



Feb 20 (M2)



May 20 (M5)



Aug 20 (M8)



Nov 20 (M11) (Non-Election Year Only)



Mar 20 (M3)



Jun 20 (M6)



Sep 20 (M9)



Dec 20 (M12) (Non-Election Year Only)



Apr 20 (M4)



Jul 20 (M7)



Oct 20 (M10)



Jan 31 (YE)

(c) 12-Day PRE-Election Report for the:



Primary (12P)



General (12G)



Runoff (12R)



Convention (12C)



Special (12S)

Election on

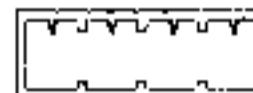

in the State of



(d) 30-Day POST-Election Report for the:



General (30G)



Runoff (30R)



Special (30S)

Election on

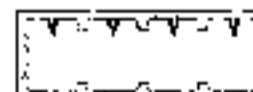
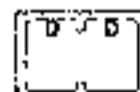

in the State of

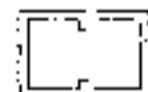

5. Covering Period

01

01

2006

through

01

31

2006

I certify that I have examined this Report and to the best of my knowledge and belief it is true, correct and complete.

Type or Print Name of Treasurer

William T. Smith

Signature of Treasurer

William T. Smith

Date

02

20

2006

NOTE: Submission of false, erroneous, or incomplete information may subject the person signing this Report to the penalties of 2 U.S.C. §437g.

Office Use Only

FEC FORM 3X Rev. 12/2004

26039003538

**SUMMARY PAGE
OF RECEIPTS AND DISBURSEMENTS**

FEC Form SX (Rev. 02/2003)

Page 2

Write or Type Committee Name

DELAWARE COUNTY DEM COMM C00404590

Report Covering the Period:

From:

To:

	COLUMN A This Period	COLUMN B Calendar Year-to-Date
6. (a) Cash on Hand January 1, <input type="text" value="2006"/>		<input type="text" value="55.14"/>
(b) Cash on Hand at Beginning of Reporting Period.....	<input type="text" value="55.14"/>	
(c) Total Receipts (from Line 19)	<input type="text" value="0"/>	<input type="text" value="0"/>
(d) Subtotal (add Lines 6(b) and 6(c) for Column A and Lines 6(a) and 6(c) for Column B)	<input type="text" value="55.14"/>	<input type="text" value="55.14"/>
7. Total Disbursements (from Line 31)	<input type="text" value="0"/>	<input type="text" value="0"/>
8. Cash on Hand at Close of Reporting Period (subtract Line 7 from Line 6(d))	<input type="text" value="55.14"/>	<input type="text" value="55.14"/>
9. Debts and Obligations Owed TO the Committee (Itemize all on Schedule C and/or Schedule D)	<input type="text" value="0"/>	
10. Debts and Obligations Owed BY the Committee (Itemize all on Schedule C and/or Schedule D)	<input type="text" value="0"/>	



This committee has qualified as a multicandidate committee. (see FEC FORM 1M)

For further information contact:

Federal Election Commission
999 E Street, NW
Washington, DC 20463

Toll Free 800-424-9530
Local 202-694-1100

26029003559

**DETAILED SUMMARY PAGE
of Receipts**

FEC Form 3X (Rev. 02/2003)

Page 3

Write or Type Committee Name

DELAWARE COUNTY DEMOCRATIC COMMITTEE

Report Covering the Period: From: 01 01 2006 To: 01 31 2006

I. Receipts	COLUMN A Total This Period	COLUMN B Calendar Year-to-Date
11. Contributions (other than loans) From:		
(a) Individuals/Persons Other Than Political Committees		
(i) Itemized (use Schedule A).....	0	0
(ii) Unitemized.....	0	0
(ii) TOTAL (add Lines 11(a)(i) and (ii)).....▶	0	0
(b) Political Party Committees.....	0	0
(c) Other Political Committees (such as PACs).....	0	0
(d) Total Contributions (add Lines 11(a)(ii), (b), and (c)) (Carry Totals to Line 33, page 5).....▶	0	0
12. Transfers From Affiliated/Other Party Committees.....	0	0
13. All Loans Received.....	0	0
14. Loan Repayments Received.....	0	0
15. Offsets To Operating Expenditures (Refunds, Rebates, etc.) (Carry Totals to Line 37, page 5).....	0	0
16. Refunds of Contributions Made to Federal Candidates and Other Political Committees.....	0	0
17. Other Federal Receipts (Dividends, Interest, etc.).....	0	0
18. Transfers from Non-Federal and Levin Funds		
(a) Non-Federal Account (from Schedule H3).....	0	0
(b) Levin Funds (from Schedule H5).....	0	0
(c) Total Transfers (add 18(a) and 18(b)).....	0	0
19. Total Receipts (add Lines 11(d), 12, 13, 14, 15, 16, 17, and 18(c)).....▶	0	0
20. Total Federal Receipts (subtract Line 18(c) from Line 19).....▶	0	0

26039003540

DETAILED SUMMARY PAGE
of Disbursements

II. Disbursements	COLUMN A Total This Period	COLUMN B Calendar Year-to-Date
21. Operating Expenditures:		
(a) Allocated Federal/Non-Federal Activity (from Schedule H4)		
(i) Federal Share	0	0
(ii) Non-Federal Share	0	0
(b) Other Federal Operating Expenditures	0	0
(c) Total Operating Expenditures (add 21(a)(i), (a)(ii), and (b))	0	0
22. Transfers to Affiliated/Other Party Committees	0	0
23. Contributions to Federal Candidates/Committees and Other Political Committees	0	0
24. Independent Expenditures (use Schedule E)	0	0
25. Coordinated Party Expenditures (2 U.S.C. §441a(d)) (use Schedule F)	0	0
26. Loan Repayments Made	0	0
27. Loans Made	0	0
28. Refunds of Contributions To:		
(a) Individuals/Persons Other Than Political Committees	0	0
(b) Political Party Committees	0	0
(c) Other Political Committees (such as PACs)	0	0
(d) Total Contribution Refunds (add Lines 28(a), (b), and (c))	0	0
29. Other Disbursements	0	0
30. Federal Election Activity (2 U.S.C. §431(20))		
(a) Allocated Federal Election Activity (from Schedule H6)		
(i) Federal Share	0	0
(ii) "Levin" Share	0	0
(b) Federal Election Activity Paid Entirely With Federal Funds	0	0
(c) Total Federal Election Activity (add Lines 30(a)(i), 30(a)(ii) and 30(b))	0	0
31. Total Disbursements (add Lines 21(c), 22, 23, 24, 25, 26, 27, 28(d), 29 and 30(c)) ..	0	0
32. Total Federal Disbursements (subtract Line 21(a)(i) and Line 30(a)(ii) from Line 31)	0	0

26039003541

DETAILED SUMMARY PAGE
of Disbursements

FEC Form 3X (Rev. 02/2003)

Page 5

III. Net Contributions/Operating Expenditures

COLUMN A
Total This Period

COLUMN B
Calendar Year-to-Date

- 33. Total Contributions (other than loans)
(from Line 11(d), page 3)
- 34. Total Contribution Refunds
(from Line 28(d))
- 35. Net Contributions (other than loans)
(subtract Line 34 from Line 33)
- 36. Total Federal Operating Expenditures
(add Line 21(a)(i) and Line 21(b))
- 37. Offsets to Operating Expenditures
(from Line 15, page 3)
- 38. Net Operating Expenditures
(subtract Line 37 from Line 36)

0
0
0
0
0
0

0
0
0
0
0
0

26039003542

Federal Election Commission
ENVELOPE REPLACEMENT PAGE FOR INCOMING DOCUMENTS
 The FEC added this page to the end of this filing to indicate how it was received.

<input type="checkbox"/> Hand Delivered	Date of Receipt
<input type="checkbox"/> USPS First Class Mail	Postmarked
<input checked="" type="checkbox"/> USPS Registered/Certified	Postmarked (R/C) 2/24/06
<input type="checkbox"/> USPS Priority Mail	Postmarked
Delivery Confirmation™ or Signature Confirmation™ Label <input type="checkbox"/>	
<input type="checkbox"/> USPS Express Mail	Postmarked
<input type="checkbox"/> Postmark Illegible	
<input type="checkbox"/> No Postmark	
<input type="checkbox"/> Overnight Delivery Service (Specify):	Shipping Date
Next Business Day Delivery <input type="checkbox"/>	
<input type="checkbox"/> Received from House Records & Registration Office	Date of Receipt
<input type="checkbox"/> Received from Senate Public Records Office	Date of Receipt
<input type="checkbox"/> Received from Electronic Filing Office	Date of Receipt
<input type="checkbox"/> Other (Specify):	Date of Receipt or Postmarked

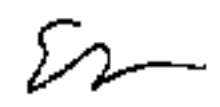
	3/1/06
PREPARER	DATE PREPARED

26039003543